

FEATURES

- Investment Cast Body Construction
- 3 Pieces Body Design
- Spring Type
- Horizontal or Vertical Installation
- Low Pressure Drop
- For General Chemical and Industrial application

SPECIFICATIONS

- Size Range DN8 ~ DN100 (1/4" ~ 4")
- End Connection Threaded Ends
- Working Pressure PN40 for DN8 ~ DN100
- Temperature Range -4 to 320 °F (-20 to 160 °C) for PTFE.

STANDARDS

- Design EN 12516-1/2/3
- Threaded End NPT/ BS 21 (BSP) / BSPT / ISO 228-1 / DIN 2999 / ISO 7-1Rp
- Socket Weld End ASME/ANSI B16.11
- Butt Weld End ASME/ANSI B16.25
- Face to Face MFG Standard
- Material EN1503-1
- Pressure Testing EN 12266

CERTIFICATE

- Quality Assurance ISO 9001
- Material Certificate EN 10204-3.1 MTR
- CE Approval PED 97/23/EC Module H

MATERIAL LIST			DIMENSION								
NO.	PART NAME	MATERIAL (more options available)	SIZE		PORT	L		L1	L2	SW	BW
			TH / SW	BW							
1	BODY	EN1503-1 1.4408	DN8	1/4"	12.0	53	63	14.0	12.0	14.0	18.0
			DN10	3/8"	12.0	53	63	14.0	12.0	17.5	19.5
4	DISC	EN1503-1 1.4408	DN15	1/2"	15.0	64	64	18.0	12.7	22.0	23.2
			DN20	3/4"	20.0	69	79	22.0	14.3	27.5	28.0
5	SPRING	SS316 WPA	DN25	1"	25.0	79	89	27.5	16.0	34.5	34.0
			DN32	1-1/4"	32.0	92	92	32.0	18.0	43.3	41.0
9	END CAP	EN1503-1 1.4408									
11	BODY SEAL	TEFLON									
35	BODY BOLT	SS304									
36	BOLT WASHER	SS304									
37	BOLT NUT	SS304									
43	HOLDER	SS316	SIZE		PORT	L		L1	L2	SW	BW
			TH / SW	BW							
			DN8	1/4"	0.47	2.08	2.48	0.55	0.47	0.55	0.70
			DN10	3/8"	0.47	2.08	2.48	0.55	0.47	0.68	0.76
43	HOLDER	SS316	DN15	1/2"	0.59	2.51	2.51	0.70	0.50	0.86	0.91
			DN20	3/4"	0.78	2.71	3.11	0.86	0.56	1.08	1.10
			DN25	1"	0.98	3.11	3.50	1.08	0.62	1.35	1.33
43	HOLDER	SS316	DN32	1-1/4"	1.25	3.62	3.62	1.25	0.70	1.70	1.61

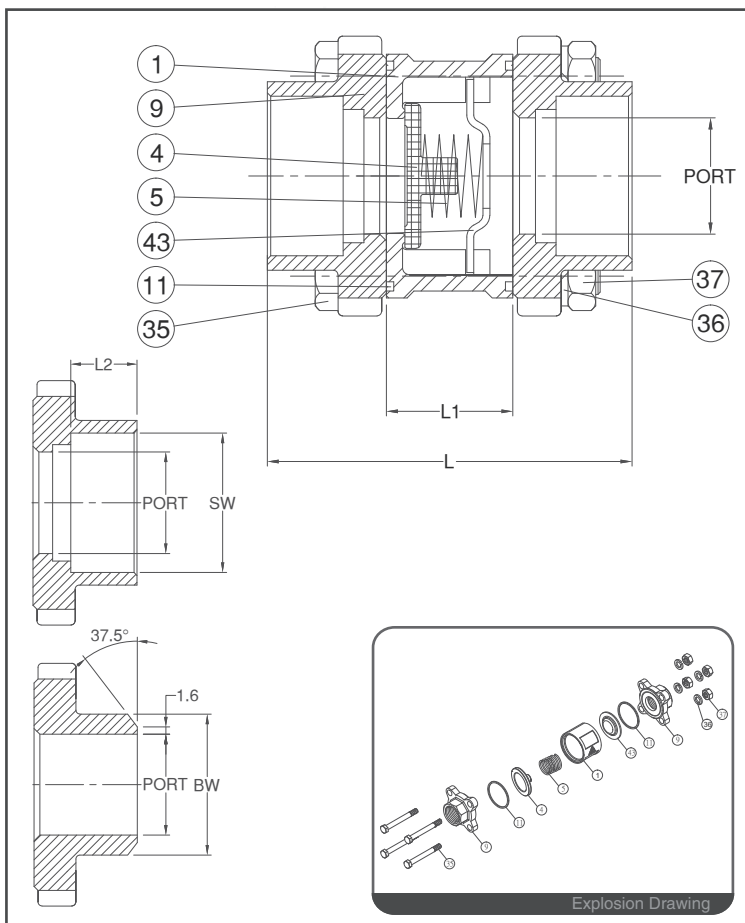

FEATURES

- Investment Cast Body Construction
- 3 Pieces Body Design
- Spring Type
- Horizontal or Vertical Installation
- Low Pressure Drop
- For General Chemical and Industrial application

SPECIFICATIONS

- Size Range DN8 ~ DN100 (1/4" ~ 4")
- End Connection Threaded Ends
- Working Pressure PN40 for DN8 ~ DN100
- Temperature Range -4 to 320 °F (-20 to 160 °C) for PTFE.

STANDARDS

- Design EN 12516-1/2/3
- Threaded End NPT/ BS 21 (BSP) / BSPT / ISO 228-1 / DIN 2999 / ISO 7-1Rp
- Socket Weld End ASME/ANSI B16.11
- Butt Weld End ASME/ANSI B16.25
- Face to Face MFG Standard
- Material EN1503-1
- Pressure Testing EN 12266

CERTIFICATE

- Quality Assurance ISO 9001
- Material Certificate EN 10204-3.1 MTR
- CE Approval PED 97/23/EC Module H

MATERIAL LIST			DIMENSION								
NO.	PART NAME	MATERIAL (more options available)	SIZE		PORT	L		L1	L2	SW	BW
			DN	INCH		TH / SW	BW				
1	BODY	EN1503-1 1.4408	DN40	1-1/2"	40.0	101	106	37	20.0	49.2	49
4	DISC	EN1503-1 1.4408	DN50	2"	50.0	115	125	47	22.5	61.2	62
5	SPRING	SS316 WPA	DN65	2-1/2"	65.0	145	150	47	27.0	77.0	78
9	END CAP	EN1503-1 1.4408	DN80	3"	80.0	154	169	55	29.0	89.9	94
			DN100	4"	100.0	180	210	70	38.0	115.0	125
			DIMENSION								
			SIZE		PORT	L		L1	L2	SW	BW
			DN	INCH		TH / SW	BW				
11	BODY SEAL	TEFLON	DN40	1-1/2"	1.57	3.97	4.17	1.45	0.78	1.93	1.92
35	BODY BOLT	SS304	DN50	2"	1.96	4.52	4.92	1.85	0.88	2.40	2.44
36	BOLT WASHER	SS304	DN65	2-1/2"	2.55	5.70	5.90	1.85	1.06	3.03	3.07
37	BOLT NUT	SS304	DN80	3"	3.14	6.06	6.65	2.16	1.14	3.53	3.70
43	HOLDER	SS316	DN100	4"	3.93	7.08	8.26	2.75	1.49	4.52	4.92